

NOTES:

- 1) The Contractor shall prepare and submit a Construction Notice of Intent (CNOI) as per the latest Mississippi Department of Environmental Quality (MDEQ) guidelines. The CNOI shall include a copy of the Storm Water Pollution Prevention Plan (SWPPP). The CNOI permit and SWPPP shall be kept on file at the job site for inspection by the MDEQ until the project is completed.
- 2) The silt fencing and other erosion control measures required shall comply with the appropriate Sections of the Mississippi Standard Specifications for State Aid Road and Bridge Construction, latest edition.
- 3) The Contractor shall install/implement additional measures as needed to take all prudent and reasonable measures to protect properties from damage caused by the construction
- 4) The Contractor shall install all the silt fencing, wattles, sediment control ponds, drainage pipes, and rock riprap required, prior to the beginning of any stripping and/or excavation.
- 5) The Contractor shall maintain a minimal buffer of undisturbed areas, where practical, around the perimeter of the site. This buffer will reduce the erosion caused by wind and water and also help reduce the amount of sediment leaving the site.
- 6) Earth fill procedures will utilize temporary diversions to eliminate surface runoff.
- 7) The Contractor shall provide for protective measures for the containment of hazardous materials, including petroleum products and lubricants, etc.
- 8) The Contractor shall provide for trash containers on site for disposal of all construction materials and prevent trash from the site from entering into the storm drainage system.
- 9) The Contractor shall inspect all installed erosion control measures and repair as necessary during the length of the construction at least every week during dry periods. The Contractor shall diligently inspect and repair, within 24 hours of a rainfall event, all erosion control measures.
- 10) The Contractor shall maintain the erosion control measures required to assure that the storm water discharged shall be free from:
 - a. Debris, oil, scum and other floating materials, other than in trace amounts;
 - b. Eroded soils and other materials that will settle to form objectionable deposits in receiving waters;
 - c. Suspended solids, turbidity and color at levels inconsistent with the receiving waters;
 - d. Chemicals in concentrations that would cause violation of the State Water Quality Criteria in the receiving waters.
- 11) The Contractor shall maintain adequate record keeping documenting inspection and repair of all erosion control measures installed.
- 12) The Contractor shall make himself familiar with the Storm Water Construction General Permit Regulations and the "Planning and Design Manual for the Control of Erosion, Sediment and Stormwater", published by the MDEQ, Mississippi Soil & Water Commission and the USDA Soil Conservation Service.
- 13) This plan contains the minimum erosion control measures to be taken. The Contractor shall utilize the BMP's outlined in the above referenced material for implementation of additional measures, as required.
- 14) Stone construction entrances required at designated entry/exit points where equipment/trucks will be entering and leaving the construction site. Construction entrances and roadway adjacent to entrances must be cleaned next day following rain event. Southern construction entrance should be moved to north of cul-de-sac once it has been constructed.
- 15) Inlet protection required around all inlets, both existing and proposed. See erosion control detail sheet.
- 16) Contractor to sod all areas that are disturbed due to construction activities, except for those to receive hardscape improvements as shown on the Plan Sheets.
- 17) Owner/Engineer will start the process to submit the LCNOI to MDEQ on behalf of the contractor before the bid opening. CONTRACTOR to transfer permit to them once project has been awarded. CONTRACTOR understands that final erosion control plan may be slightly different per MDEQ comments/revision requests.
- 18) Skimmer required at detention pond during construction, and/or until permanent erosion control measures are in place, as approved by the ENGINEER. See Sheet C901 for Skimmer Discharge System details.

V:\Data Partners\2025-349-00 Meridian High School Baseball_Softball_1\Production Drawings\Sheet\C900 - Erosion Control_Plan.dwg 8/10/2023 4:18 PM

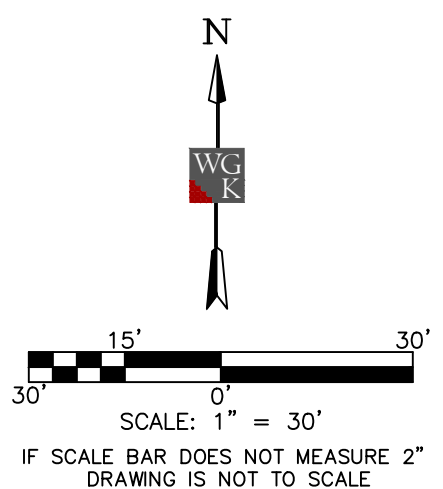
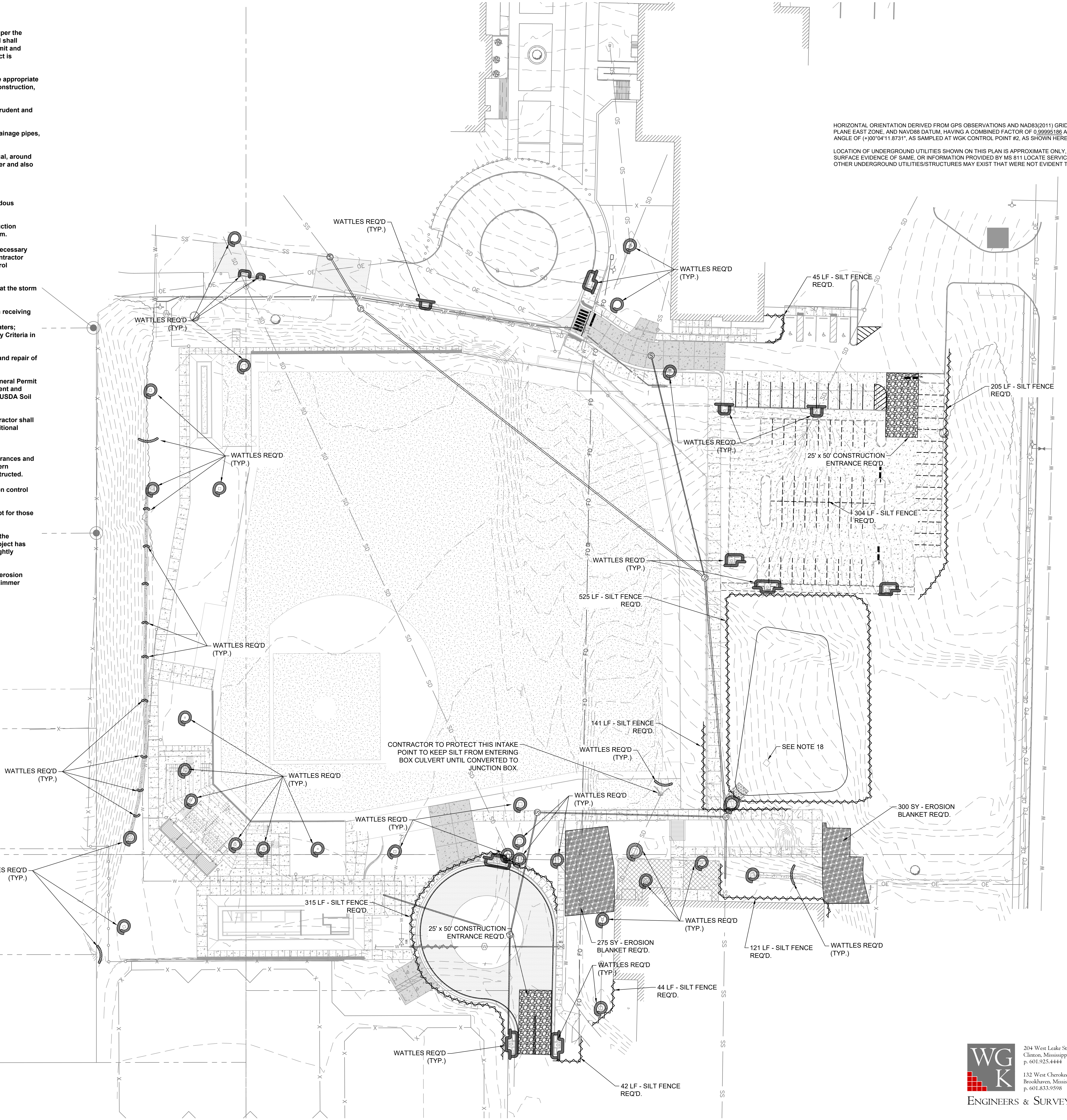

HORIZONTAL ORIENTATION DERIVED FROM GPS OBSERVATIONS AND NAD83(2011) GRID DATA, MISSISSIPPI STATE PLANE EAST ZONE, AND NAVD88 DATUM, HAVING A COMBINED FACTOR OF 0.99995188 AND A CONVERGENCE ANGLE OF (+00°04'11.8731\"/>

DALE BAILEY
AN ASSOCIATION

Architects

One Jackson Place 250
188 East Capitol Street
Jackson, MS 39201
p 601.352.5411

201 Park Court Suite B
Ridgeland, MS 39157
p 601.790.9432

161 Lameuse St. Suite 201
Biloxi, MS 39530
p 228.374.1409

dalebaileyplans.com



**Meridian High School
Baseball/Softball Re-Bid**
2320 32nd St, Meridian, MS 39305

Construction Documents

Project No	22034-03
Date	8/10/23
Revisions	Rev Date
Addendum #1	8/10/23

WG K
ENGINEERS & SURVEYORS

204 West Leake Street
Clinton, Mississippi 39056
p. 601.925.4444

132 West Cherokee Street
Brookhaven, Mississippi 39601
p. 601.833.9598

C-900
Erosion Control Plan



SKIMMER NOTES:

- SKIMMER SHOWN IS A FAIRCLOTH SKIMMER, BY J.W. FAIRCLOTH & SON, HILLSBOROUGH NORTH CAROLINA. CONTRACTOR TO USE SIMILAR, OR BETTER.
- PROPER ORIFICE OPENING MUST BE SELECTED TO ENSURE POND DRAINS IN CORRECT AMOUNT OF TIME. MODIFICATIONS MAY BE REQUIRED IF FIELD CONDITIONS WARRANT A CHANGE.
- EMBANKMENT MUST BE COMPACTED TO DESIGN SPECIFICATIONS.
- EMERGENCY SPILLWAY MUST BE CORRECTLY SIZED AND EROSION PROTECTION INSTALLED.
- EROSION PROTECTION MUST BE INSTALLED ALONG THE EMBANKMENT AND AT THE DISCHARGE END OF THE PIPE.
- INSPECT SYSTEM REGULARLY TO ENSURE IT IS FUNCTIONING IN A CORRECT MANNER.

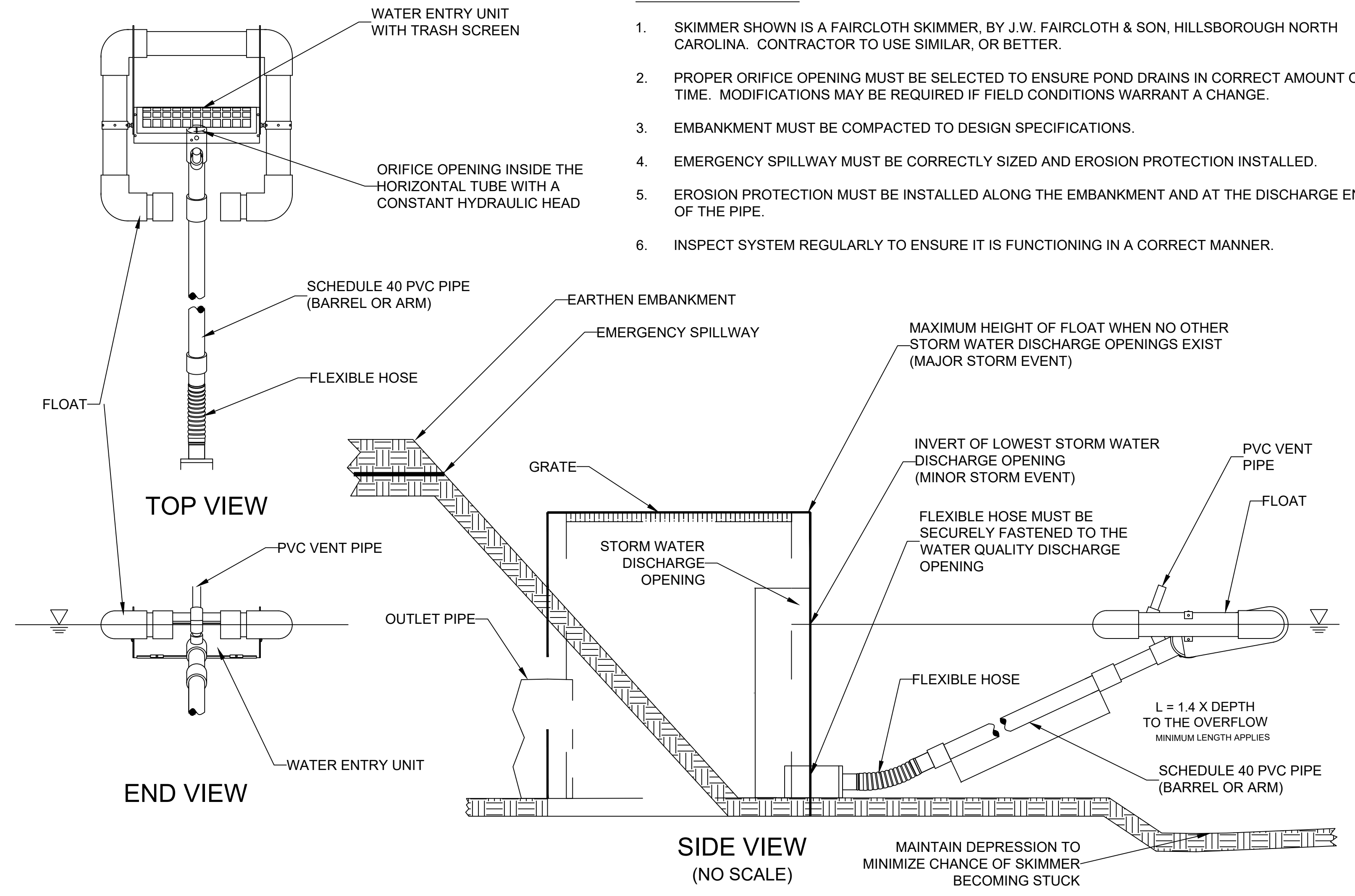

SKIMMER SIZE	FLOW CAPACITIES (IN CU. FT.) FOR THE FAIRCLOTH SKIMMER							
	1.5"	2"	2.5"	3"	4"	5"	6"	8"
24 HOURS	1,728	3,283	6,234	9,774	20,109	32,832	51,840	97,978
2 DAY	3,456	6,566	12,468	19,548	40,218	65,664	103,680	195,956
3 DAY	5,184	9,849	18,702	29,322	60,327	98,496	155,520	293,934
4 DAY	6,912	13,132	24,936	39,096	80,436	131,328	207,360	391,912
5 DAY	8,640	16,415	31,170	48,870	100,545	164,160	259,200	489,890
6 DAY	10,368	19,698	37,404	58,644	120,654	196,992	311,040	587,868
7 DAY	12,096	22,981	43,638	68,418	140,763	229,824	362,880	685,846

SKIMMER DISCHARGE SYSTEM WITH OUTLET STRUCTURE
N.T.S.

General Notes

- The Contractor shall complete the Construction Notice of Intent contained in the Contract Documents.
- The silt fencing required shall comply with Section 234 of the Mississippi Standard Specifications for Road and Bridge Construction, latest edition.
- The Contractor shall install/implement additional measures as needed and take all prudent and reasonable measures to protect properties from damage caused by the construction.
- The Contractor shall install all the silt fencing, straw bales, sediment and diversion berms as directed by the Engineer.
- The Contractor shall provide protective measures for the containment of hazardous materials, including petroleum products and lubricants, etc.
- The Contractor shall provide trash containers on site for disposal of all construction materials, and shall prevent trash from entering the storm drainage system.
- The Contractor shall inspect all installed erosion control measures, and shall repair as necessary during the length of the construction (at least every seven (7) days during dry periods.) The Contractor shall diligently inspect and repair, within 24 hours of a rainfall event, all erosion control measures.
- The Contractor shall maintain the erosion control measures to assure that the storm water discharged shall be free from:
 - Debris, oil, scum and other floating materials, other than in trace amounts;
 - Eroded soils and other materials that will settle to form objectionable deposits in receiving waters;
 - Suspended solids, turbidity and color at levels inconsistent with the receiving waters;
 - Chemicals in concentrations that would cause violation of the State Water Quality Criteria in the receiving waters.
- The Contractor shall maintain adequate record keeping documenting inspection and repair of all erosion control measures installed.
- The Contractor shall make himself familiar with the Storm Water Construction General Permit Regulations and the "Planning and Design Manual for the Control of Erosion, Sediment and Stormwater", published by the MDEQ, Mississippi Soil & Water Commission and the USDA Soil Conservation Service.

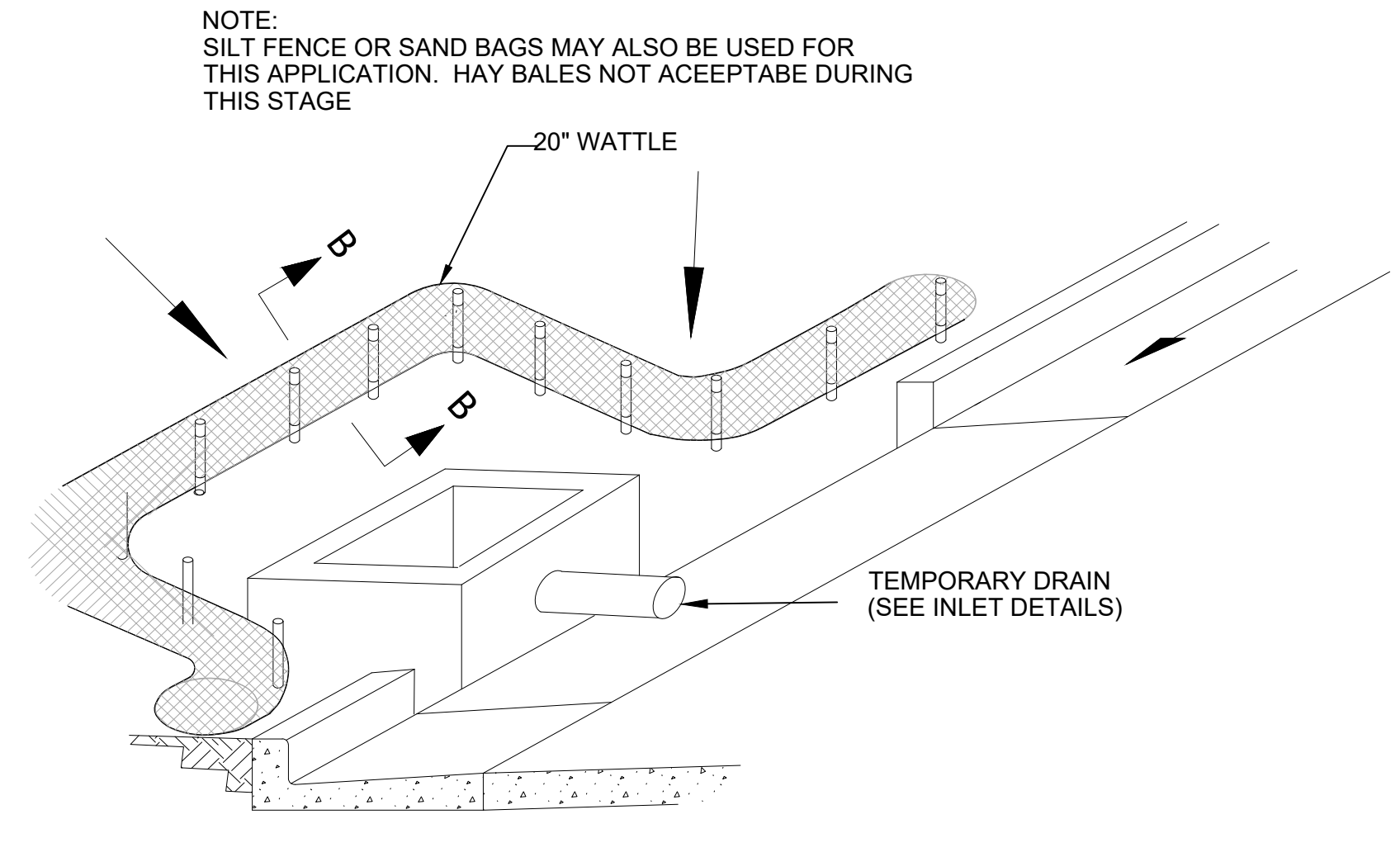

**CURB INLET PROTECTION (STAGE 2)
SINGLE OR DOUBLE WING INLET**

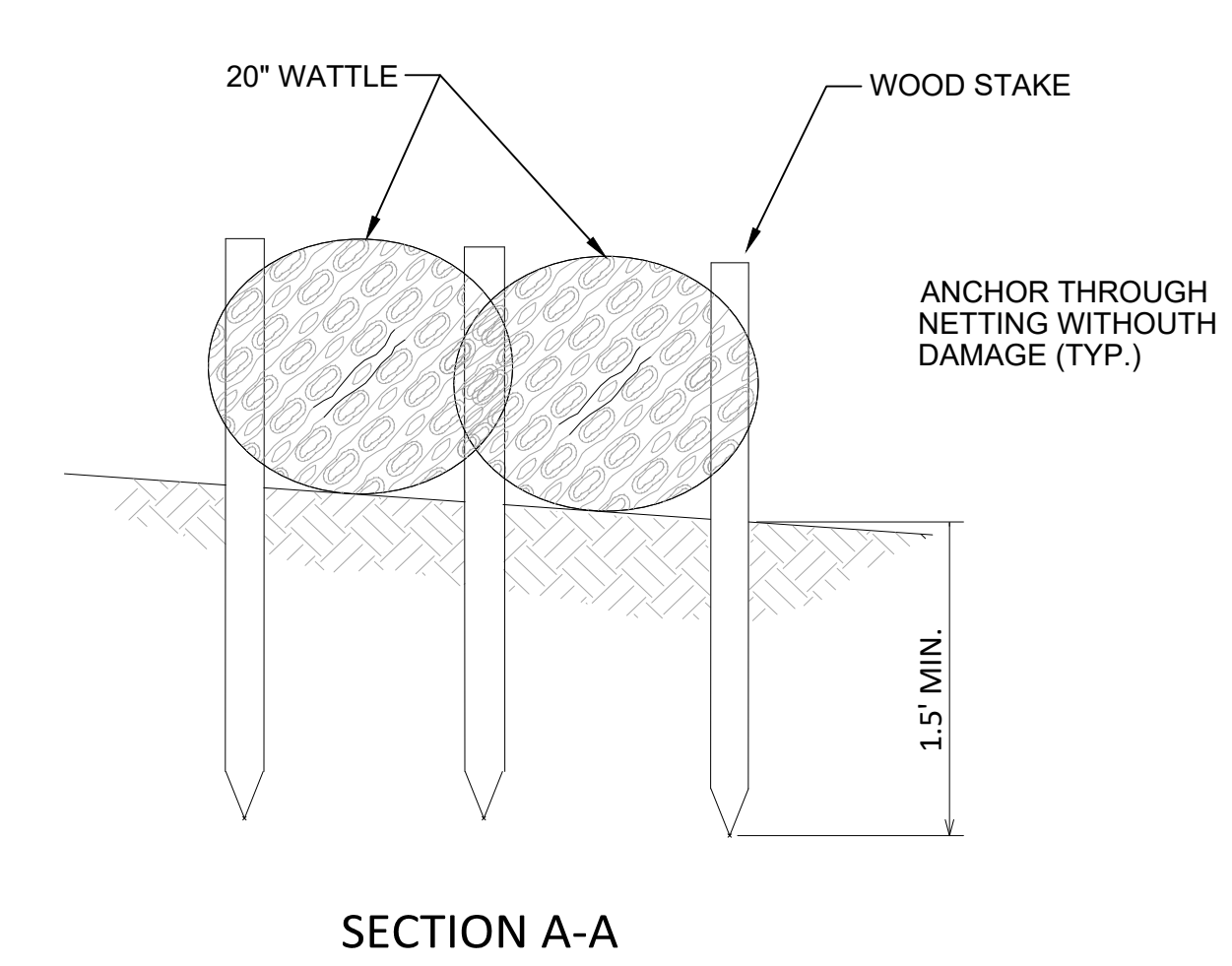

SECTION A-A

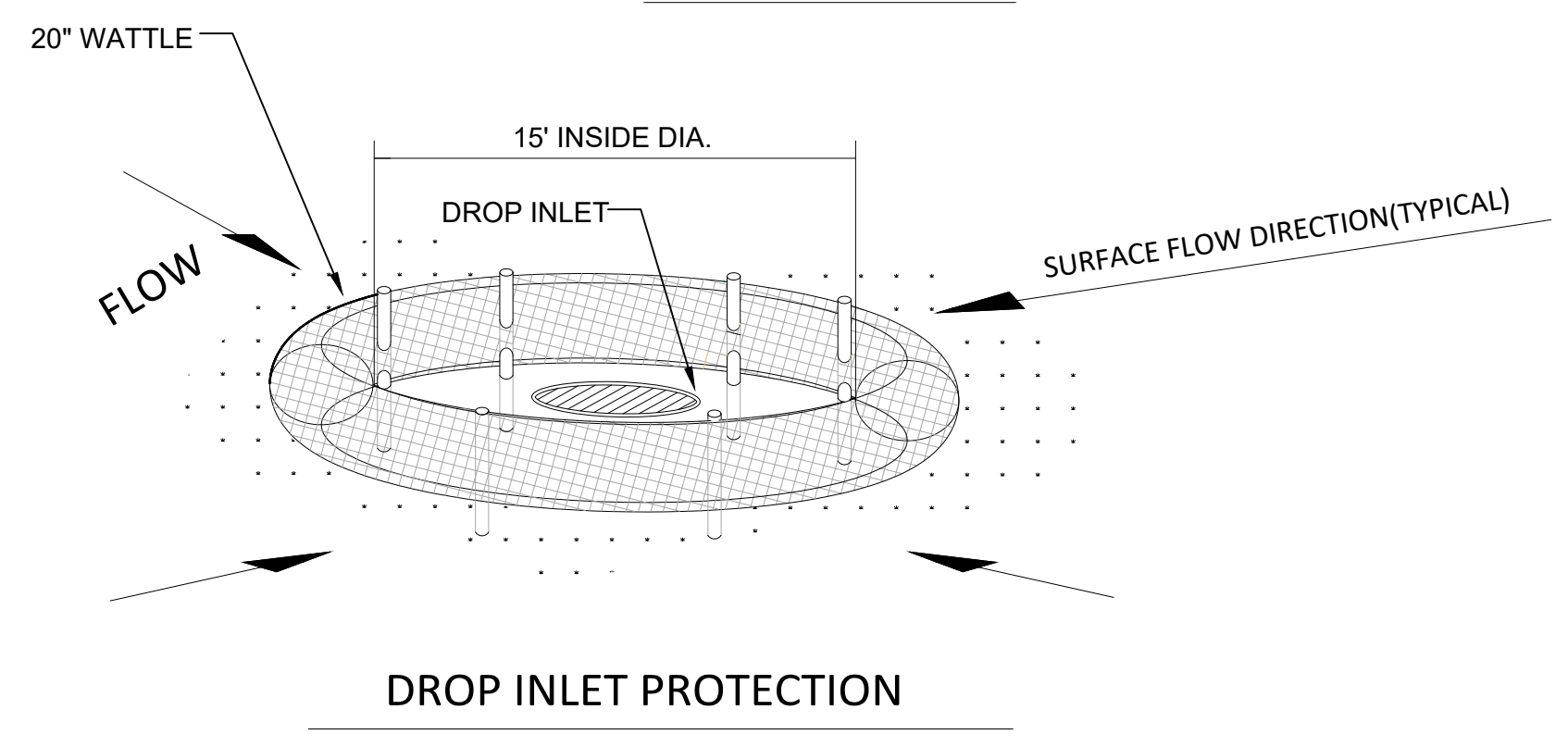

DROP INLET PROTECTION

- NOTES:**
- ANCHORING STAKES SHALL BE SIZED, SPACED, AND BE OF A MATERIAL THAT EFFECTIVELY SECURES THE WATTLE. STAKE SPACING SHALL BE A MAXIMUM OF THREE FEET.
 - OVERLAP ENDS OF WATTLES PER MANUFACTURER'S RECOMMENDATIONS (1" MAX., 3" MAX.).
 - TRENCHING OF WATTLES MAY BE NECESSARY IF PIPING BECOMES EVIDENT.

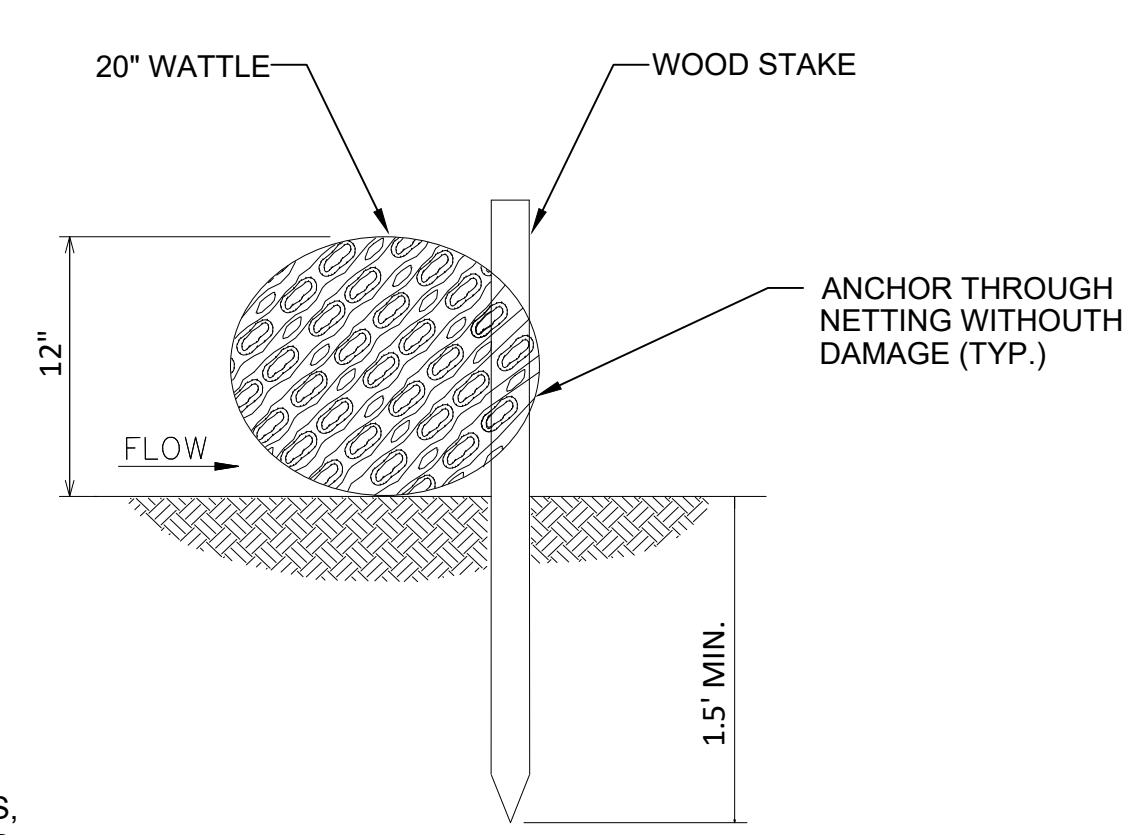

SECTION B-B

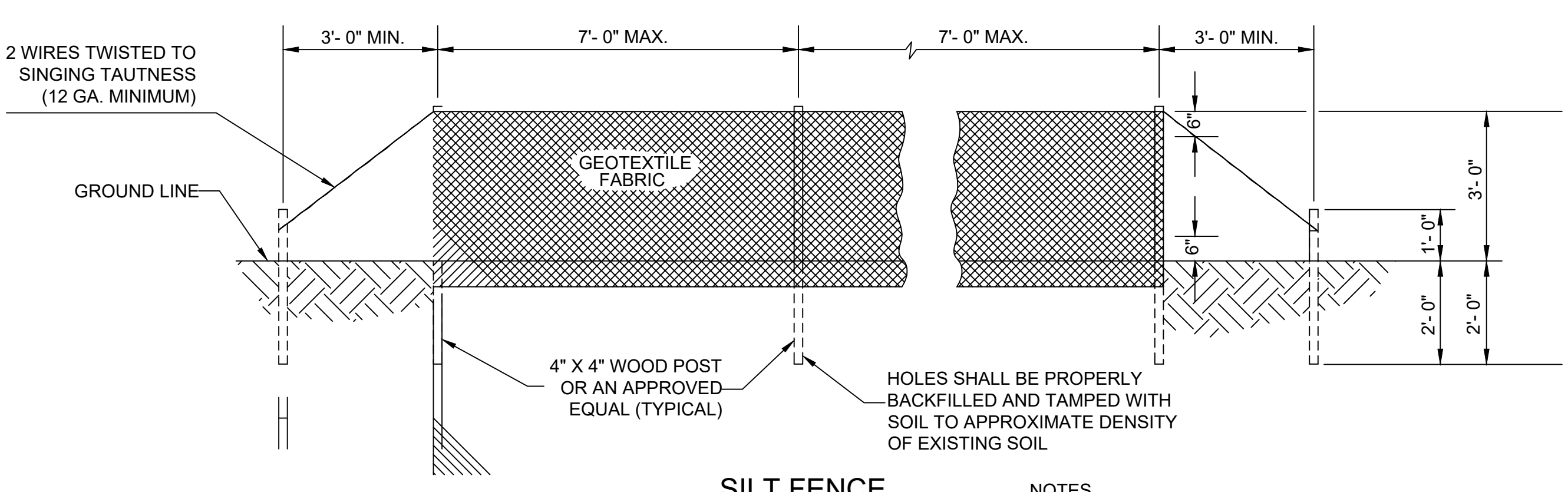

SECTION

SILT FENCE

- NOTES**
- SILT FENCES ARE TEMPORARY EROSION CONTROL ITEMS THAT SHALL BE ERECTED OPPOSITE ERODIBLE AREAS SUCH AS NEWLY GRADED FILL SLOPES AND ADJACENT TO STREAMS AND CHANNELS.
 - SILT FENCE SHOULD BE PLACED WELL INSIDE PROPERTY BOUNDARY AND ALONG EDGE OF CLEARING LIMITS. THIS WILL ALLOW ROOM FOR A BACK-UP FENCE IF FIRST BECOMES FULL. SILT FENCES SHALL BE IN PLACE PRIOR TO ANY CONSTRUCTION OPERATION.
 - WHEREVER POSSIBLE, SILT FENCES SHALL BE CONSTRUCTED ACROSS A FLAT AREA IN THE SHAPE OF A HORSESHOE. THIS AIDS IN PONDING OF RUNOFF AND FACILITATES SEDIMENTATION.
 - AFTER THE CONSTRUCTION AREA IS STABILIZED AND EROSION ACTIVITY CURTAILED, SILT FENCES SHALL BE REMOVED.
 - RING FASTENERS USED TO SECURE GEOTEXTILES TO WOVEN WIRE SHALL BE 13 GA. (AMERICAN).
 - IF WOOD POSTS ARE USED, STAPLES FOR SECURING WOVEN WIRE TO POSTS SHALL BE NINE (9) GAUGE, GALVANIZED, 1 1/2" LONG, FIVE (5) PER POST @ APPROXIMATELY 1'-0" ON CENTER.
 - WOVEN WIRE TO BE 12 1/2 GAUGE (MINIMUM).

SPECIFICATIONS
CURRENT MISSISSIPPI DEPARTMENT OF TRANSPORTATION

SECTION

TYPICAL SILT FENCE INSTALLATION

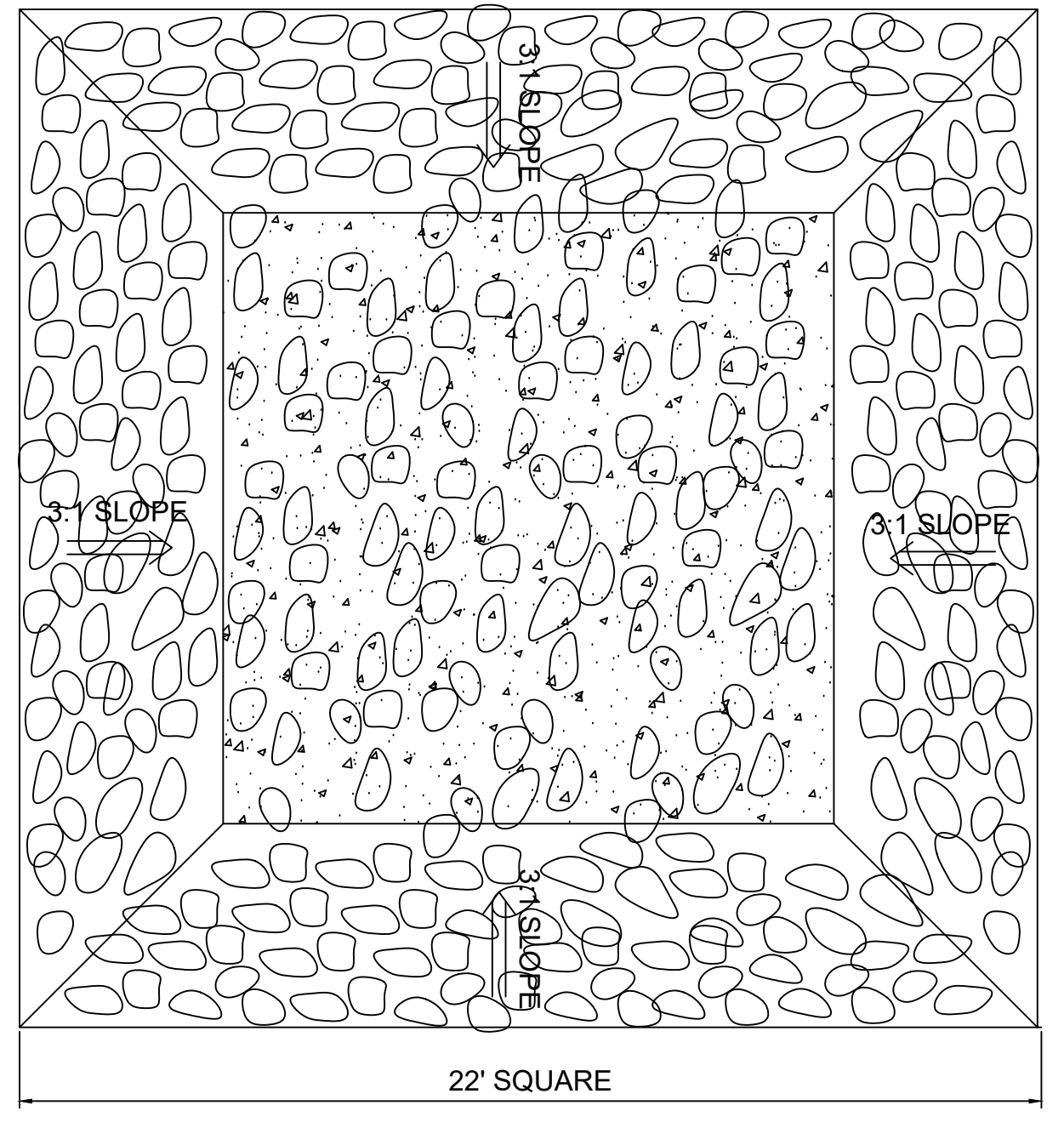

**PLUNGE POOL DETAIL
NOT TO SCALE**

NOTE: GROUTED ROCK RIPRAP ON BOTTOM ONLY

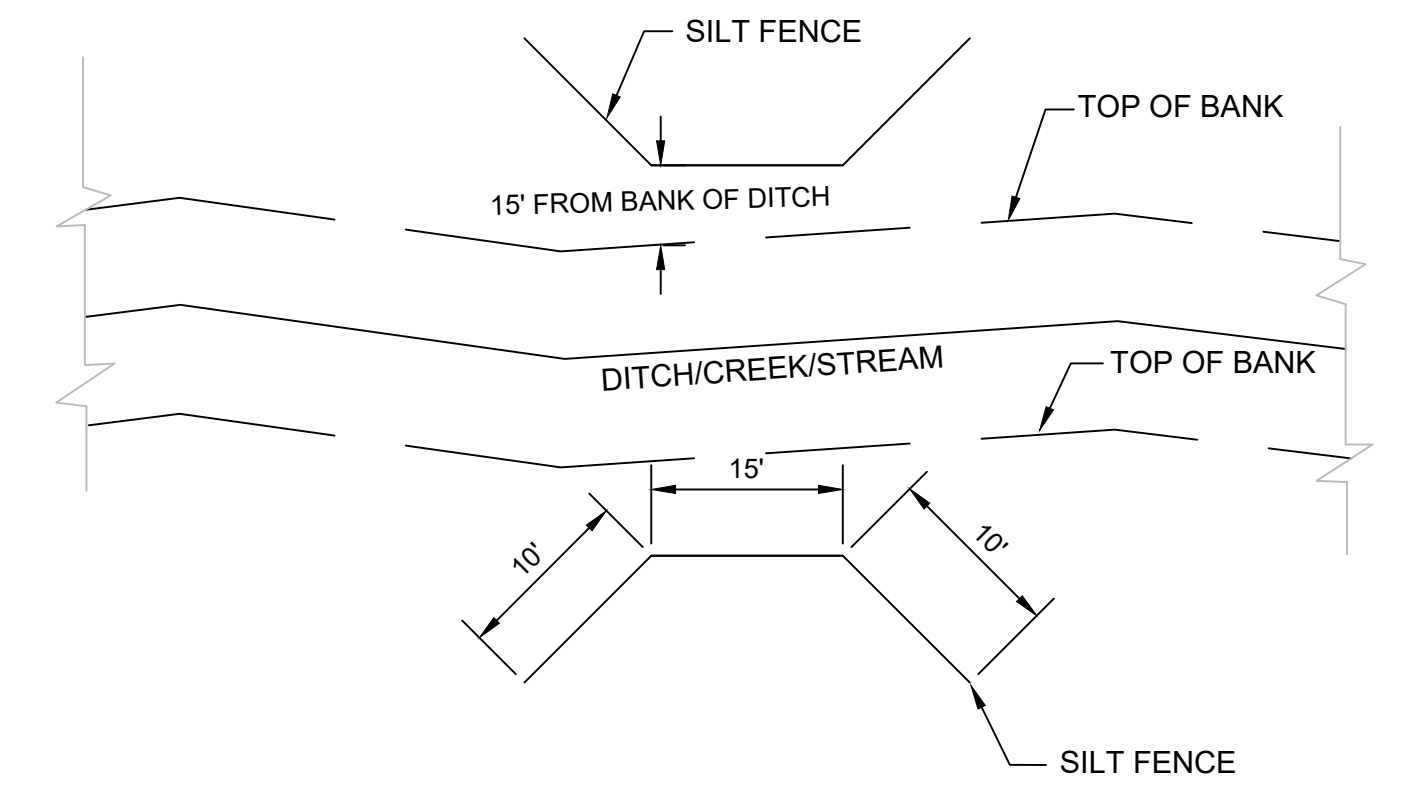

SILT FENCE AT DITCH DETAIL

N.T.S.

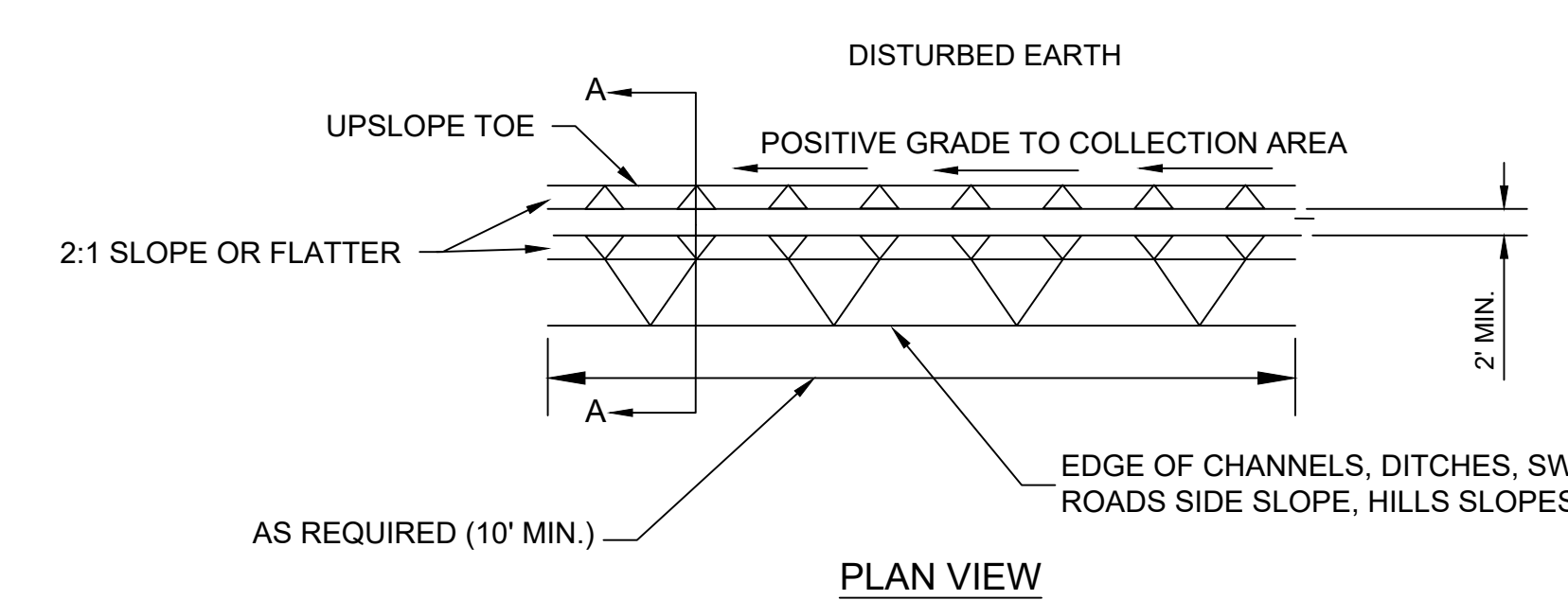

PLAN VIEW

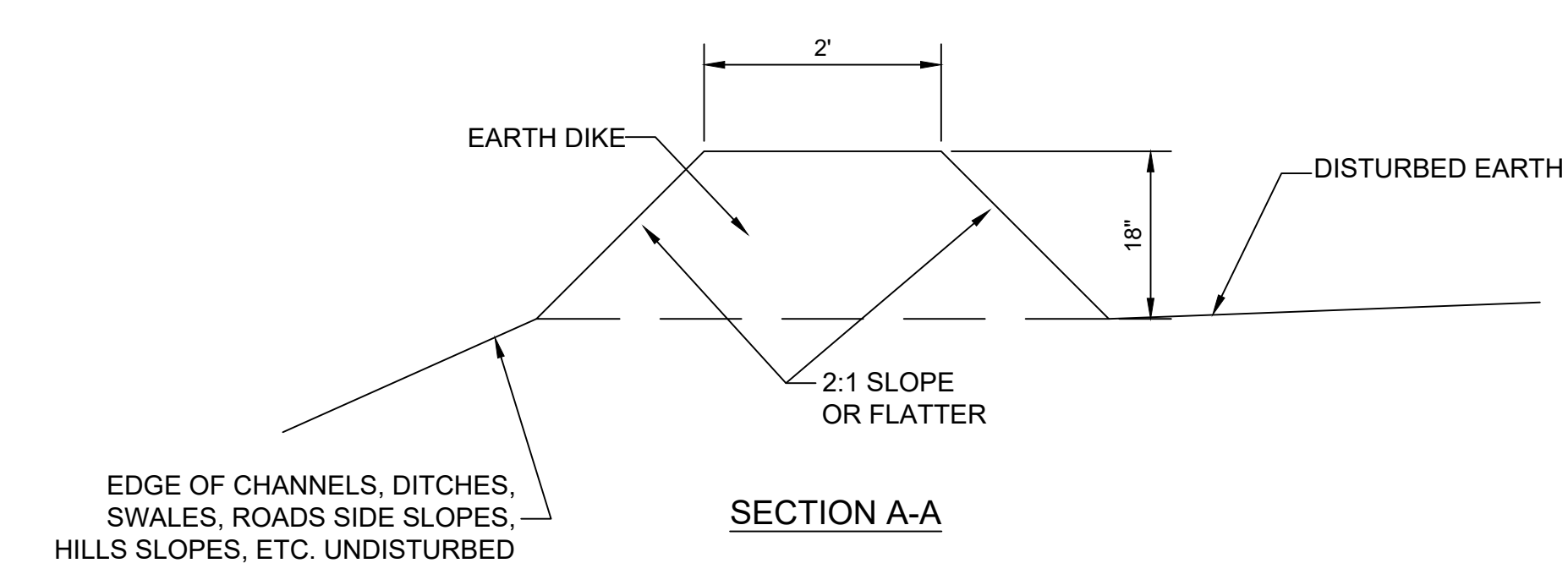

SECTION A-A

DIVERSION BERM DETAIL

N.T.S.