

SECTION 009113 – ADDENDUM ONE

PART 1 - ADDENDA

1.1 PROJECT INFORMATION

- A. Project Name: 22034.02 Meridian High School
- B. Owner: Meridian Public School District, 1019 25th Avenue, Meridian, MS 38391
- C. Architect: Dale | Bailey, an Association, One Jackson Place, Suite 250, 188 East Capitol Street, Jackson, MS 39201-2100
- D. Architect Project Number: 22034.02
- E. Date of Addendum One: 30 August 2023



1.2 NOTICE TO BIDDERS

- A. This Addendum is issued to all registered plan holders pursuant to the Instructions to Bidders and Conditions of the Contract. This Addendum serves to clarify, revise, and supersede information in the Project Manual, Drawings, and previously issued Addenda. Portions of the Addendum affecting the Contract Documents will be incorporated into the Contract by enumeration of the Addendum in the Owner/Contractor Agreement.
- B. The Bidder shall acknowledge receipt of this Addendum in the appropriate space on the Bid Form.
- C. The date for receipt of bids is unchanged by this Addendum at same time and location.

1.3 GENERAL

- A. Attached are the annotated Pre-Bid Meeting Minutes and Meeting Attendees dated 29 August 2023.

1.4 GENERAL RESPONSES TO REQUESTS FOR INFORMATION

- A. QUESTION: Will the architect consider waiving requirements associated with AWI/QCP?
ANSWER: Yes.

1.5 REVISIONS TO DIVISION 00 - PROCUREMENT REQUIREMENTS AND CONTRACTING REQUIREMENTS

- A. DOCUMENT 004113 – BID FORM. Delete this form in its entirety and replace it with new. See attached. Added Alternate #3.

1.6 REVISIONS TO DIVISION 01 – GENERAL REQUIREMENTS

- A. DOCUMENT 012300 – ALTERNATES. Delete this form in its entirety and replace it with new. See attached. Added Alternate #3.

1.7 REVISIONS TO TECHNICAL SPECIFICATIONS

- A. 321216 – ASPHALT CONCRETE PAVEMENT (1900 Addition). New. Add to the project manual.
- B. 321216 – ASPHALT CONCRETE PAVEMENT (2004 Addition). New. Add to the project manual.

1.8 REVISIONS TO DRAWINGS

- A. SHEET C-301 -- SITE PLAN (Revised). Added sidewalk and asphalt repair.

1.9 ATTACHMENTS

- A. Annotated Pre-Bid Meeting Minutes and Meeting Attendees dated 29 August 2023.
- B. This Addendum includes the following attached Specifications.
 - 1. Specification 004113 – Bid Form dated 30 August 2023.
 - 2. Specification 012300 – Alternates dated 30 August 2023.
 - 3. Specification 321216 – Asphalt Concrete Pavement (1900 Addition) dated 30 August 2023.
 - 4. Specification 321216 - Asphalt Concrete Pavement (2004 Addition) dated 30 August 2023.
- C. This Addendum includes the following attached Drawings.
 - 1. Sheet C – 301 – Site Plan dated 30 August 2023.

END OF ADDENDUM ONE

Agenda

08/30/23 Meeting Minutes

201 Park Court, Suite B
Ridgeland, MS 39157
P 601.790.9432
F 888.281.0547

29 August 2023

22034.02 Meridian High School / Pre-Bid Meeting

One Jackson Place, Suite 250
188 East Capitol Street
Jackson, MS 39201-2100
P 601.352.5411
F 601.352.5362

161 Lameuse Street, Suite 201
Biloxi, MS 39530
P 228.374.1409
F 228.374.1414

1. General

- a. Please silence cell phones
- b. Sign-in sheet: Minutes will include list of meeting attendees
- c. Plan holders list: Minutes will include list of plan holders
- a. Description: Project includes the construction of two major additions and minor renovations using bond issue funds for the Meridian School District at Meridian Senior High School campus. Site demo and repair as well as regrading, parking lot installation, & new construction using steel and masonry systems are all included.

2. Team

- a. Owner..... Meridian Public School District
 - i. Superintendent Dr. Amy Carter
 - ii. Director of Operations Clay Sims
- b. Bailey Program Manager Jason Stewart
- c. Architect Dale Bailey Architects/Jackson Mississippi
 - 1. principal in charge Russ Blount
 - 2. project manager Paul Purser
- d. Mechanical GSK mechanical, Inc./Jason Kackley / 601.605.2930
- e. Electrical The Power Source PLLC / Chris Green / 601.605.4820
- f. Structural Structural Design Group / William Grigg / 615.255.5537
- g. Civil WGK, Inc. / Brandon Mckay / 601.925.4444

3. Procurement and Contracting Requirements

- a. Advertisement for Bids
 - i. Advertisement dates: 08.15.23 & 08.22.23
 - ii. Bid Receipt: Bids to be opened at 2:00 PM on Tuesday, September 12, 2023
 - iii. Bid Location: Meridian Public School District, 1019 25th Avenue, Meridian, MS 39301.
- b. Bidder Qualifications
 - i. Bidders must be properly licensed under the laws governing their respective trades
 - ii. List all applicable state & local license & registration nos. on outside of bid envelope

- c. Bonding & Insurance
 - i. Bidders must be able to obtain insurance and bonds required for the Work
- d. Bid Security
 - i. A Bid Security in the amount of 5% of the total maximum bid amount is required
 - ii. Cash, cashier's check, certified check, US money order, or bid bond
- e. Bid Form and Attachments
 - i. Acknowledgement of Addenda
 - ii. Subcontractor identification
- f. Bid Submittal Requirements
 - i. Envelope requirements (re: Bid Submittal Checklist)
 - ii. Proper identification
- g. Notice of Award
 - i. Offered within 60 days after receipt of bids
 - ii. Award will be made as soon as possible & successful bidder should be ready to secure bonds & insurance immediately

4. Communication during Bidding Period

- a. Obtaining documents
 - i. Plan holders are required to register and order bid documents at www.dalebaileyplans.com
- b. Bidder's Requests for Information
 - i. Binding answers to questions must be included in an official written addendum and the Contractor or Subcontractor is encouraged to provide written communications to the Architect for proper response
 - ii. Address e-mailed written correspondence to biddinginfo@dalepartners.com
 - iii. No questions will be accepted after 5:00 PM on Friday September 8, 2023 in order to allow the Architect adequate time to prepare any necessary addenda
- c. Addenda
 - i. Addendum no 1 (issued) 08.30.23
 - ii. Addendum no 2 (tentative)..... TBD
 - iii. Addendum no 3 (tentative)..... TBD
 - iv. final addendum (if required)TBD

5. Contracting Requirements

- a. The Supplementary Conditions
 - i. Refer to this section for specific comments & directives
 - 1. Change order markups
 - 2. Weather delays -there shall be no extension of time due to weather
 - 3. Retainage
 - 4. Stored material
 - 5. Insurance
 - 6. Project to conform with Federal Davis Bacon act requirements
 - b. Other Owner requirements: verify user occupancy during construction

6. Construction Documents

- a. Use of Site
 - i. Parking **A designated area will be defined by the owner; times and events could affect**
 - ii. Lay-down area
 - 1. Lay down as noted on sheet RC101
- b. Work Restrictions
 - i. Work days
 - ii. Work times
- c. Unit prices, alternates, & allowances
 - i. Unit prices:
 - 1. Unit Price 01: Provide a price for lime material \$_____ / Ton.
 - 2. Unit Price 02: Provide a price for mixing lime material \$_____ / Sq Yard.
 - ii. Alternates:
 - 1. Alternate No. 01: Canopy work in the North Courtyard, as labeled on A-100, and for the entirety of the west and south sides of the courtyard otherwise roughly measuring 145'-1" from north to south and 172'-1" from east to west. _____ Dollars (\$_____).
 - 2. Alternate No. 02: Canopy work in the North Courtyard, as labeled on A-100, and for the entirety of the east and north sides of the courtyard otherwise roughly measuring 67'-0" from north to south and 193'-10" from east to west. _____ Dollars (\$_____).
 - 3. New Alternate for Band Hall Addition; to be addressed in upcoming addendum
 - iii. Allowances:
 - 1. Allowance No. 01: Lump Sum Contingency Allowance of Two Hundred Fifty Thousand Dollars (\$250,000.00).
 - 2. Allowance No. 02: Utility Power Allowance of Forty Thousand Dollars (\$40,000.00).

- d. Substitutions following award
 - i. Substitutions will be considered within 30 days of the contract award
 - ii. Burden of proof of "equal" will be on the Contractor or Vendor

7. Schedule

- a. Project Schedule
 - i. GC to provide CPM type schedule, regularly updated
- b. Contract Time
 - i. estimated notice to proceed date – TBD – Date of contract signing
 - ii. Project to be fully complete by February 15, 2025.
- c. Liquidated Damages
 - i. \$500 each calendar day of the delay after Contract Time
- d. Other Bidder Questions

8. Post-Meeting Addendum

- a. May be issued, as necessary to document the meeting questions & provide proper responses

9. Other Bidder Questions

- a. Minutes of meeting are issued as Available Information and do not constitute a modification to the Procurement and Contracting Documents
- b. Modifications to the Procurement and Contracting Documents are issued by written Addendum only

10. Site/facility visit or walkthrough

End

Q: There is a turf spec in the table of contents; will turf be required for this project?

A: No.

Q: What is the expectation for repair to field and track at the fine arts addition?

A: Contractor is required to protect surfaces and any damage shall be repaired to like new condition.

Additional comments:

1 Other work is being performed throughout campus by other contractors; coordination will be required with other contractors.

2 Dirt work for the new parking lot will be installed/graded by the baseball stadium contractor. Parking lot installation for THIS project will not move forward until the other contractor has completed their dirt work and compaction testing has been completed. The baseball stadium contractor has a completion date for the parking lot grading of December 31, 2023.

Paul Purser, Architect, DBA



Meeting Attendees

201 Park Court, Suite B
 Ridgeland, MS 39157
 P 601.790.9432
 F 888.281.0547

29 August 2023

22034.02 Meridian High School Additions & Renovations / Pre-Bid Meeting

One Jackson Place, Suite 250
 188 East Capitol Street
 Jackson, MS 39201-2100
 P 601.352.5411
 F 601.352.5362

161 Lameuse Street, Suite 201
 Biloxi, MS 39530
 P 228.374.1409
 F 228.374.1414

	Name	Company	Phone	Email
1	Dr. Amy Carter	Meridian PSD		amcarter@mpsdk12.net
2	Clay Sims <i>[Signature]</i>	Meridian PSD		csims@mpsdconnect.org
3	Jason Stewart <i>[Signature]</i>	Bailey Program Man.		jstewart@bailey-pm.com
4	Paul Purser <i>[Signature]</i>	Dale Bailey	(601) 506-9093	paulpurser@dalepartners.com
5	<i>Chris Deeper Benchmark 601-540-8881 CDDEPER@BENCHMARK</i>			
6	Jay Joyner <i>[Signature]</i>	J+J	601-917-0650	jay.joyner@jjcont.com
7				
8				
9				
10				
11				
12				
13				
14				
15				

M9.COM

DOCUMENT 004113 - BID FORM - STIPULATED SUM (SINGLE-PRIME CONTRACT)

1.1 BID INFORMATION

- A. Bidder: _____.
- B. Project Name: Meridian High School Additions and Renovations.
- C. Project Location: 2320 32nd St, Meridian, MS 39305.
- D. Owner: Meridian Public School District, 1019 25th Avenue, Meridian, MS 38391.
- E. Architect: Dale | Bailey, An Association, One Jackson Place, Suite 250, 188 East Capitol Street, Jackson, MS 39201-2100.
- F. Architect Project Number: 22034.02.

1.2 CERTIFICATIONS AND BASE BID

- A. Base Bid, Single-Prime (All Trades) Contract: The undersigned Bidder, having carefully examined the Procurement and Contracting Requirements, Conditions of the Contract, Drawings, Specifications, and all subsequent Addenda, as prepared by Dale|Bailey and Architect's consultants, having visited the site, and being familiar with all conditions and requirements of the Work, hereby agrees to furnish all material, labor, equipment and services, including all scheduled allowances, necessary to complete the construction of the above-named project, according to the requirements of the Procurement and Contracting Documents, for the stipulated sum of:
1. _____ Dollars
(\$_____).
 2. The above amount may be modified by amounts indicated by the Bidder on the attached Document 004322 "Unit Prices Form" and Document 004323 "Alternates Form."

1.3 ALLOWANCES. Include the allowances below in the base bid. Refer to section 012100-ALLOWANCES.

- A. Allowance No. 01: Lump Sum Contingency Allowance of Two Hundred Fifty Thousand Dollars (\$250,000.00).
- B. Allowance No. 02: Utility Power Allowance of Forty Thousand Dollars (\$40,000.00).

1.4 UNIT RATES. Refer to Section 012200 - Unit Prices for description of Unit Prices.

- A. Unit Price 01: Provide a price for lime material \$ _____ / Ton.
- B. Unit Price 02: Provide a price for mixing lime material \$ _____ / Sq Yard.

1.5 ALTERNATES. Refer to Section 012300 - Alternates for description of Alternates.

- A. Additive Alternate No. 01: Canopy work in the North Courtyard, as labeled on A-100, and for the entirety of the west and south sides of the courtyard otherwise roughly measuring 145'-1" from north to south and 172'-1" from east to west.

_____ Dollars

(\$_____).

- B. Alternate No. 02: Canopy work in the North Courtyard, as labeled on A-100, and for the entirety of the east and north sides of the courtyard otherwise roughly measuring 67'-0" from north to south and 193'-10" from east to west.

_____ Dollars

(\$_____).

- C. Alternate No. 03: Provide all work pertaining to the addition at band hall as an alternate. This work includes everything beyond the existing exterior walls for the construction of all levels of the addition including demolition directly related to the structure.

_____ Dollars

(\$_____).

1.6 BID GUARANTEE

- A. The undersigned Bidder agrees to execute a contract for this Work in the above amount and to furnish surety as specified within 10 . days after a written Notice of Award, if offered within 90 days after receipt of bids, and on failure to do so agrees to forfeit to Owner the attached cash, cashier's check, certified check, U.S. money order, or bid bond, as liquidated damages for such failure, in the following amount constituting five percent (5%) of the Base Bid amount above:

1. _____ Dollars

(\$_____).

- B. In the event Owner does not offer Notice of Award within the time limits stated above, Owner will return to the undersigned the cash, cashier's check, certified check, U.S. money order, or bid bond.

1.7 SUBCONTRACTORS AND SUPPLIERS

- A. The following companies shall execute subcontracts for the portions of the Work indicated:

1. Concrete Work: _____.

2. Masonry Work: _____.

- 3. Roofing Work: _____.
- 4. Plumbing Work: _____.
- 5. HVAC Work: _____.
- 6. Electrical Work: _____.

1.8 TIME OF COMPLETION

- A. Successful bidder shall begin the Work on receipt of the Notice to Proceed and shall complete the Work by Substantial Completion February 15, 2025. The work is subject to liquidated damages.

1.9 ACKNOWLEDGMENT OF ADDENDA

- A. The undersigned Bidder acknowledges receipt of and use of the following Addenda in the preparation of this Bid:
 - 1. Addendum No. 1, dated _____.
 - 2. Addendum No. 2, dated _____.
 - 3. Addendum No. 3, dated _____.
 - 4. Addendum No. 4, dated _____.

1.10 BID SUPPLEMENTS

- A. The following supplements are a part of this Bid Form and are attached hereto.
 - 1. Bid Form Supplement - Bid Bond Form (AIA Document A310-2010).

1.11 CONTRACTOR'S LICENSE

- A. The undersigned further states that it is a duly licensed contractor, for the type of work proposed, in Mississippi, and that all fees, permits, etc., pursuant to submitting this proposal have been paid in full.

1.12 SUBMISSION OF BID

- A. Respectfully submitted this _____ day of _____, 2023.
- B. Submitted By: _____ (Name of bidding firm or corporation).
- C. Authorized Signature: _____ (Handwritten signature).
- D. Signed By: _____ (Type or print name).

Addendum One
Meridian High School
Additions and Renovations
Meridian, Mississippi

- E. Title: _____ (Owner/Partner/President/Vice President).
- F. Witnessed By: _____ (Handwritten signature).
- G. Attest: _____ (Handwritten signature).
- H. By: _____ (Type or print name).
- I. Title: _____ (Corporate Secretary or Assistant Secretary).
- J. Street Address: _____.
- K. City, State, Zip: _____.
- L. Email: _____.
- M. Phone: _____.
- N. License No.: _____.
- O. Federal ID No.: _____ (Affix Corporate Seal Here).

END OF DOCUMENT 004113

SECTION 012300 - ALTERNATES

PART 1 - GENERAL

1.1 SUMMARY

- A. Section includes administrative and procedural requirements for alternates.

1.2 DEFINITIONS

- A. Alternate: An amount proposed by bidders and stated on the Bid Form for certain work defined in the bidding requirements that may be added to or deducted from the base bid amount if the Owner decides to accept a corresponding change either in the amount of construction to be completed or in the products, materials, equipment, systems, or installation methods described in the Contract Documents.
 - 1. Alternates described in this Section are part of the Work only if enumerated in the Agreement.
 - 2. The cost or credit for each alternate is the net addition to or deduction from the Contract Sum to incorporate alternates into the Work. No other adjustments are made to the Contract Sum.

1.3 PROCEDURES

- A. Coordination: Revise or adjust affected adjacent work as necessary to completely integrate work of the alternate into Project.
 - 1. Include as part of each alternate, miscellaneous devices, accessory objects, and similar items incidental to or required for a complete installation whether or not indicated as part of alternate.
- B. Execute accepted alternates under the same conditions as other work of the Contract.
- C. Schedule: A schedule of alternates is included at the end of this Section. Specification Sections referenced in schedule contain requirements for materials necessary to achieve the work described under each alternate.

PART 2 - PRODUCTS (Not Used)

PART 3 - EXECUTION

3.1 SCHEDULE OF ALTERNATES

- A. Alternate No. 01 : Canopy work in the North Courtyard, as labeled on A-100, and for the entirety of the west and south sides of the courtyard otherwise roughly measuring 145'-1" from north to south and 172'-1" from east to west.
- B. Alternate No. 02: Canopy work in the North Courtyard, as labeled on A-100, and for the entirety of the east and north sides of the courtyard otherwise roughly measuring 67'-0" from north to south and 193'-10" from east to west.
- C. Alternate No. 03: Provide all work pertaining to the addition at band hall as an alternate. This work includes everything beyond the existing exterior walls for the construction of all levels of the addition including demolition directly related to the structure. Base bid shall not include new VCT at the existing band hall, but shall include new ceilings, lighting, and paint at all previously painted surfaces within the existing band hall. No new wall assemblies shall be included within the existing fine arts space but shall be included in the alternate. No mechanical work shall be included for the fine arts building within the base bid but shall be included in the alternate. Contractor shall include foundation work and platform for other project's HVAC equipment noted on RA102/5.

END OF SECTION 012300

PART 1 - GENERAL

1-01 DESCRIPTION

- A. This item shall include the furnishing of all labor, materials, equipment and incidentals necessary and required for paving roadways, driveways, and parking areas in accordance with the contract Drawings and these Specifications.
- B. Paving shall be performed with machinery equipped with a 40 foot ski attachment for proper grade control, so that a smooth riding surface is achieved.
- C. Any required adjustments of existing utility manholes, valves and appurtenances will be performed by CONTRACTOR as necessary.
- D. Dimensions shall be as indicated on the Drawings.
- E. Where reference is made to the Mississippi Department of Transportation (formerly the Mississippi State Highway Department Specifications - MSHD), it is intended to be in accordance with the Mississippi Standard Specifications for Road and Bridge Construction, Mississippi State Highway Department, 1990 Edition.

PART 2 - MATERIALS

2-01 GENERAL

- A. All materials for asphalt paving and related work shall comply with Mississippi Standard Specifications for Road and Bridge Construction, MSHD, 1990 Edition as follows:
 - 1. Plant mix pavements - General - Section 401
 - 2. Base course - Section 301
 - 3. Tack Coat - Section 407
 - 4. Binder course - Section 403
 - 5. Surface course - Section 403
- B. As used in this specification, the following abbreviations shall apply:
 - 1. BB - Black Base
 - 2. TC - Tack Coat
 - 3. BC - Binder Course
 - 4. SC - Surface Course
- C. The term "course" used in this Section shall be understood to mean a layer of specified thickness shown on the plans and for which quantities are estimated on the plans and in the proposal as the basis for bidding. A course may, in some cases consist of a single layer, and, in other cases, may consist of two or more layers depending on the finished thickness specified.
- D. The CONTRACTOR shall retain a certified testing laboratory and pay all costs associated with conforming to these Specifications.

PART 3 - EXECUTION

3-01 BASE COURSE (BLACK BASE): Number BB-1, Type 6

- A. General: Where indicated on the Drawings this work shall consist of the construction of a base course in one or more courses composed of mineral aggregates in the proportions specified and placed hot. The base course shall be constructed on a prepared subgrade foundation in accordance with these specifications and in close conformity with the thickness, lines, grades and sections as shown on the plans.
- B. The base course shall comply with Section 301, Plant Mix Bituminous Base Course, of the Mississippi State Highway Department Specifications.
- C. A job mix formula shall be submitted to the ENGINEER for review prior to placing any base material. See Paragraph E of this section.
- D. The job mix formula shall be set within the master range as indicated below. The job mix formula shall be maintained within the job mix tolerance and shall not exceed the limits of the ranges.
 - 1. The job mix temperatures shall be between 225 degrees Fahrenheit minimum and 340 degrees Fahrenheit maximum with a tolerance of +/-25 degrees Fahrenheit.
 - 2. The job mix formula as approved shall be considered as tentative until a sufficient amount of the mixture has been processed through the plant, spread and compacted.
 - 3. Extractions shall be made on samples of each mixture, produced by the plant, before any mixture is placed on the project.
 - 4. After the job mix formula is approved, the mixture furnished to the project shall remain unchanged, within the tolerances specified for the mixture, throughout the duration of the job. No change in properties or proportions of any ingredient of the mix shall be made without written permission of the ENGINEER.
- E. The gradation of the mixture shall meet the following requirements:

<u>Sieve Size</u>	<u>Percentage Passing Sieve (by Weight)</u>	<u>Tolerances For Approved Job Mix Formula</u>
1 - 1/2 inch	100	+7%
1 inch	83 - 100	7%
3/4 inch	---	---
1/2 inch	56 - 95	+7%
3/8 inch	---	---
No. 4	29 - 70	+7%
No. 8	19 - 54	+6%
No. 30	8 - 30	+6%
No. 50	4 - 20	+6%
No. 200	2 - 10	+6%
Min. % Asphalt Cement by weight of mix	4.0	+0.5%

- F. Bituminous Materials shall be petroleum asphalt cement grade AC-30, unless otherwise specified.

- G. Mineral filler shall meet the requirements of Section 703.16 of the Mississippi State Highway Department Specifications. Mineral filler may be used as necessary to obtain desired properties; however, excessive use shall not be permitted in the mix.
- H. Weather Limitations: Base course shall be placed on a dry unfrozen surface and only when the air temperature in the shade is above 40 degrees F. and rising, or above 50 degrees F. when falling, and when the weather is not rainy or foggy.
- I. Density: The average lot density shall not be less than 92.0 percent nor more than 95.0 percent of the maximum density based on AASHTO Designation T209.
- J. Base course shall be placed in layers not to exceed four (4) inches in thickness, unless approved by the ENGINEER.
- K. Surface tolerance shall conform to the designated grade and cross section within the tolerances set forth in Section 3.01.03.2 of MSHD Specifications.

3-02 TACK COAT (Required Full Width)

- A. General: This work shall consist of preparing and treating a clay gravel base, an existing bituminous base or an existing concrete base with bituminous material in accordance with those shown on the plans or established by the ENGINEER. A tack coat shall be applied, for the full width of the course to be superimposed on a previously prepared and bonded clay gravel base, bituminized road surface or base, or concrete surface or base. The tack coat may be omitted from a previously primed road when deemed by the ENGINEER to be unnecessary.
- B. Tack coat is to be applied between each lift or course of asphalt pavement unless otherwise specified by the ENGINEER.
- C. A tack coat shall be applied over the base course and shall consist of 0.08 to 0.12 gallons per square yard of bituminous material grade AC-20 as specified in Section 407 of the MSHD Specification.
- D. Tack coat shall not be applied during wet or cold weather, after sunset or to a wet surface, and only on as much pavement as can be covered with additional courses in the same day. The surface to receive tack coat shall be prepared in accordance with Section 401.03.6 and 410.034 of MSHD Specifications.
- E. Separate Payment for tack coat shall not be made. The tack coat shall be an absorbed item.

3-03 BINDER COURSE, Number BC-1, Type 6

- A. This work shall consist of the construction of a binder course to thickness indicated on drawings, in accordance with these Contract Drawings, these specifications and the Mississippi State Highway Department Specification 403, Hot Bituminous Pavement.
- B. A job mix formula shall be submitted to the ENGINEER for review prior to placing any binder course. See Paragraph C of this section.
- C. The gradation of the aggregates for the mixture shall meet the following requirements:

<u>Sieve Size</u>	<u>Percentage Passing Sieves</u>	<u>Tolerances</u>
3/4 inch	100	+5%
1/2 inch	82 - 100	+5%
3/8 inch	71 - 91	+5%
4	40 - 73	+5%
8	26 - 58	+3%
30	9 - 30	+3%
50	6 - 20	+3%
200	2 - 10	+1.5%
Min. % Asphalt Cement by weight of mix	4.0	+0.3%

- D. Bituminous materials shall be petroleum asphalt cement grade AC-20.
- E. Density: The average percent density of samples obtained shall be at least 96% of the average laboratory density.
- F. Mineral filler shall meet the requirements of Section 703.16 of the MSHD Specifications. Mineral filler may be used as necessary to obtain desired properties; however, excessive use shall not be permitted in the mix.
- G. Tests for stability determination, if required, will be made in accordance with Section 700.03, MSHD Specifications.
- H. Weather Limitations: Binder courses shall be placed only when the air temperature in the shade is 50 degrees F. or above, and the weather is not rainy or foggy.
- I. Surface Tolerances: Surface tolerances shall conform to the designated grades and cross section, within the tolerances set forth in Section 403.03.2 Tolerances of MSHD Specifications.

3-04 SURFACE COURSE, Number SC-1, Type 2 or 8

- A. This work shall consist of the construction of a surface course, thickness indicated on drawings, in accordance with the Contract Drawings, these specifications and the Mississippi State Highway Department Specification 403, Hot Bituminous Pavement.
- B. A job mix formula shall be submitted to the ENGINEER for review prior to placing any surface course. See Paragraph C of this section.
- C. The gradation of the aggregates for the mixture shall meet the following requirements. Not less than 40% of the material passing the No. 10 sieve shall be retained on the No. 40 sieve for this gradation.
- D. At least 40% but not more than 50% by weight of the aggregate retained on the No. 10 sieve shall be either crushed gravel, crushed limestone, crushed slag, or crushed granite, as required by the type specified.

<u>Sieve Size</u>	<u>Percent Passing Sieves</u>	<u>Tolerances</u>
1/2 inch	100	+/-5%
3/8 inch	87 - 100	+/-5%
4	54 - 80	+/-5%
8	32 - 63	+/-3%
3	12 - 33	+/-3%
50	6 - 20	+/-3%
200	2 - 10	+/-1.5%
Min % Asphalt Cement by wt. of mix	4.0	+/-0.3%

- E. Bituminous materials shall be petroleum asphalt cement grade AC-20.
- F. Density: The average percent density of samples obtained from the completed pavement shall be at least 96 percent (96%) of the average laboratory density.
- G. Mineral filler shall meet the requirements of Section 703.16 of the MSHD Specifications. Mineral filler may be used as necessary to obtain desired properties; however, excessive use shall not be permitted in the mix.
- H. Tests for stability determination, if required, will be made in accordance with Section 700.03, MSHD Specifications.
- I. Weather Limitations: Surface courses shall be placed only when the air temperature in the shade is 50 degrees F. or above, and the weather is not rainy or foggy.
- J. Surface Tolerances: Surface tolerances shall conform to the designated grades and cross section, within the tolerances set forth in Section 403.03.2 Tolerances of MSHD Specifications.

3-05 PRE-ROLLING

- A. Prior to application of base course, the sub-base shall be pre-rolled as may be required to determine possible presence of underlying soil failures in accordance with Section 411 of MSHD Specifications.

3-06 TESTING

- A. The CONTRACTOR shall have the testing laboratory furnish certified gradation analysis of aggregates for binder and surface course and for material to be installed in the base course. These results shall be reviewed by the ENGINEER prior to the use of the material tested.
- B. Density testing shall be paid for by the CONTRACTOR, and taken a minimum of one (1) for each 10,000 square feet of pavement installed, or fraction thereof.
- C. Results of all testing shall be submitted to the ENGINEER in triplicate.
- D. Any prior use testing or certification costs shall be borne by the Contractors. Testing of the plant mix in the laboratory shall be paid for by the CONTRACTOR.

END OF DOCUMENT 321216

PART 1 - GENERAL

1-01 DESCRIPTION

- A. This item shall include the furnishing of all labor, materials, equipment and incidentals necessary and required for paving roadways, driveways, and parking areas in accordance with the contract Drawings and these Specifications.
- B. Paving shall be performed with machinery equipped with a 40 foot ski attachment for proper grade control, so that a smooth riding surface is achieved.
- C. Any required adjustments of existing utility manholes, valves and appurtenances will be performed by CONTRACTOR as necessary.
- D. Dimensions shall be as indicated on the Drawings.
- E. Where reference is made to the Mississippi Department of Transportation, it is intended to be in accordance with the Mississippi Standard Specifications for Road and Bridge Construction, Mississippi State Highway Department, 2004 Edition.

PART 2 - MATERIALS

2-01 GENERAL

- A. All materials for asphalt paving and related work shall comply with Mississippi Standard Specifications for Road and Bridge Construction, MDOT, 2004 Edition as follows:
 - 1. Hot Mix Asphalt (HMA) – General - Section 401
 - 2. Hot Mix Asphalt Pavement – Section 403
 - 3. Tack Coat - Section 407
 - 4. Utility Adjustments - Section 613
- B. The term "course" used in this Section shall be understood to mean a layer of specified thickness shown on the plans and for which quantities are estimated on the plans and in the proposal as the basis for bidding. A course may, in some cases consist of a single layer, and, in other cases, may consist of two or more layers depending on the finished thickness specified.
- C. The CONTRACTOR shall retain a certified testing laboratory and pay all costs associated with conforming to these Specifications.

PART 3 - EXECUTION

3-01 BASE COURSE (25mm and 19mm Mixes):

- A. General: Where indicated on the Drawings this work shall consist of the construction of a base course in one or more courses composed of mineral aggregates in the proportions specified and placed hot. The base course shall be constructed on a prepared subgrade foundation in accordance with these specifications and in close conformity with the thickness, lines, grades and sections as shown on the plans.
- B. The base course shall comply with Section 403 of the MDOT Specifications.

- C. A job mix formula shall be submitted to the ENGINEER for review prior to placing any base material. See Paragraph E of this section.
- D. The job mix formula shall be set within the master range as indicated below. The job mix formula shall be maintained within the job mix tolerance and shall not exceed the limits of the ranges.
1. The job mix temperatures shall be between 225 degrees Fahrenheit minimum and 340 degrees Fahrenheit maximum with a tolerance of +/-25 degrees Fahrenheit.
 2. The job mix formula as approved shall be considered as tentative until a sufficient amount of the mixture has been processed through the plant, spread and compacted.
 3. Extractions shall be made on samples of each mixture, produced by the plant, before any mixture is placed on the project.
 4. After the job mix formula is approved, the mixture furnished to the project shall remain unchanged, within the tolerances specified for the mixture, throughout the duration of the job. No change in properties or proportions of any ingredient of the mix shall be made without written permission of the ENGINEER.
- E. The gradation of the mixture shall meet the requirements as shown in the Design Master Range found in Section 401.02.1.2.3.
- F. Bituminous Materials shall be petroleum asphalt cement grade PG 67-22, unless otherwise specified.
- G. Mineral filler shall meet the requirements of Section 703.16 of the MDOT Specifications. Mineral filler may be used as necessary to obtain desired properties; however, excessive use shall not be permitted in the mix.
- H. Weather Limitations: Base course shall be placed on a dry unfrozen surface and only when the air temperature in the shade is above 40 degrees F. and rising, or above 50 degrees F. when falling, and when the weather is not rainy or foggy.
- I. Density:
- a. For all single lift overlays, with or without, leveling and/or milling, the required lot density shall be 92.0 percent of maximum density.
 - b. For all multiple lift overlays of two (2) or more lifts, excluding leveling lifts, the required lot density of the bottom lift shall be 92.0 percent of maximum density and subsequent lifts shall have a 93.0 percent of maximum density.
 - c. For all pavements on new construction, the required lot density for all lifts shall be 93.0 percent of maximum density
 - d. Maximum density for asphalt lots shall be 95.0 percent of maximum density.
- J. Base course shall be placed in layers not to exceed four (4) inches in thickness, unless approved by the ENGINEER.
- K. Surface tolerance shall conform to the designated grade and cross section within the tolerances set forth in Section 403.03.2 of MDOT Specifications.

3-02 TACK COAT (Required Full Width)

- A. General: This work shall consist of preparing and treating a clay gravel base, an existing bituminous

base or an existing concrete base with bituminous material in accordance with those shown on the plans or established by the ENGINEER. A tack coat shall be applied, for the full width of the course to be superimposed on a previously prepared and bonded clay gravel base, bituminized road surface or base, or concrete surface or base. The tack coat may be omitted from a previously primed road when deemed by the ENGINEER to be unnecessary.

- B. Tack coat is to be applied between each lift or course of asphalt pavement unless otherwise specified by the ENGINEER.
- C. A tack coat shall be applied over the base course and shall consist of 0.05 to 0.10 gallons per square yard of bituminous material grade RC-70 as specified in Section 410 of the MDOT Specification.
- D. Tack coat shall be applied with a distributor spray bar. A hand wand will only be allowed for applying tack coat on ramp pads, irregular shoulder areas, median crossovers, turnouts or irregular areas.
- E. Tack coat shall not be applied during wet or cold weather, after sunset or to a wet surface, and only on as much pavement as can be covered with additional courses in the same day. The surface to receive tack coat shall be prepared in accordance with Section 401.03.6 and 410.03.04 of MDOT Specifications.
- E. Separate Payment for tack coat shall not be made. The tack coat shall be an absorbed item.

3-03 LEVELING/SURFACE COURSE: (12.5mm, 9.5mm and 4.75mm Mixes)

- A. This work shall consist of the construction of a surface course, thickness indicated on drawings, in accordance with the Contract Drawings, these specifications and the Mississippi State Highway Department Specification 403, Hot Bituminous Pavement.
- B. A job mix formula shall be submitted to the ENGINEER for review prior to placing any surface course. See Paragraph C of this section.
- C. The gradation of the mixture shall meet the requirements as shown in the Design Master Range found in Section 401.02.1.2.3.
- D. Bituminous materials shall be petroleum asphalt cement grade PG 67-22.
- E. Density: The average percent density of samples obtained from the completed pavement shall be at least 92 percent (92%) of the average laboratory density for single lift overlays; all multiple lift asphalts shall be 92 percent (92%) of the average laboratory density for the bottom lift and 93% for subsequent lifts; all pavements on new construction shall be 93 percent (93%) of the average laboratory density.
- F. Mineral filler shall meet the requirements of Section 703.16 of the MSHD Specifications. Mineral filler may be used as necessary to obtain desired properties; however, excessive use shall not be permitted in the mix.
- G. Tests for stability determination, if required, will be made in accordance with Section 700.03, MDOT Specifications.
- H. Weather Limitations: Surface courses shall be placed only when the air temperature in the shade is 50 degrees F. or above, and the weather is not rainy or foggy.
- I. Surface Tolerances: Surface tolerances shall conform to the designated grades and cross section, within the tolerances set forth in Section 403.03.02 Tolerances of MDOT Specifications.

3-04 PRE-ROLLING

- A. Prior to application of base course, the sub-base shall be pre-rolled as may be required to determine possible presence of underlying soil failures.

3-05 TESTING

- A. The CONTRACTOR shall have the testing laboratory furnish certified gradation analysis of aggregates for binder and surface course and for material to be installed in the base course. These results shall be reviewed by the ENGINEER prior to the use of the material tested.
- B. Density testing shall be paid for by the CONTRACTOR, and taken a minimum of one (1) for each 10,000 square feet of pavement installed, or fraction thereof.
- C. Results of all testing shall be submitted to the ENGINEER in triplicate.
- D. Any prior use testing or certification costs shall be borne by the Contractors. Testing of the plant mix in the laboratory shall be paid for by the CONTRACTOR.

END OF DOCUMENT 321216



Meridian High School Additions & Renovations

2320 32nd St, Meridian, MS 39305

Project No	22034.02
Date	08/15/2023
Drawn	CS
Checked	BLM
Revision #	Date
Addendum #1	08/30/23

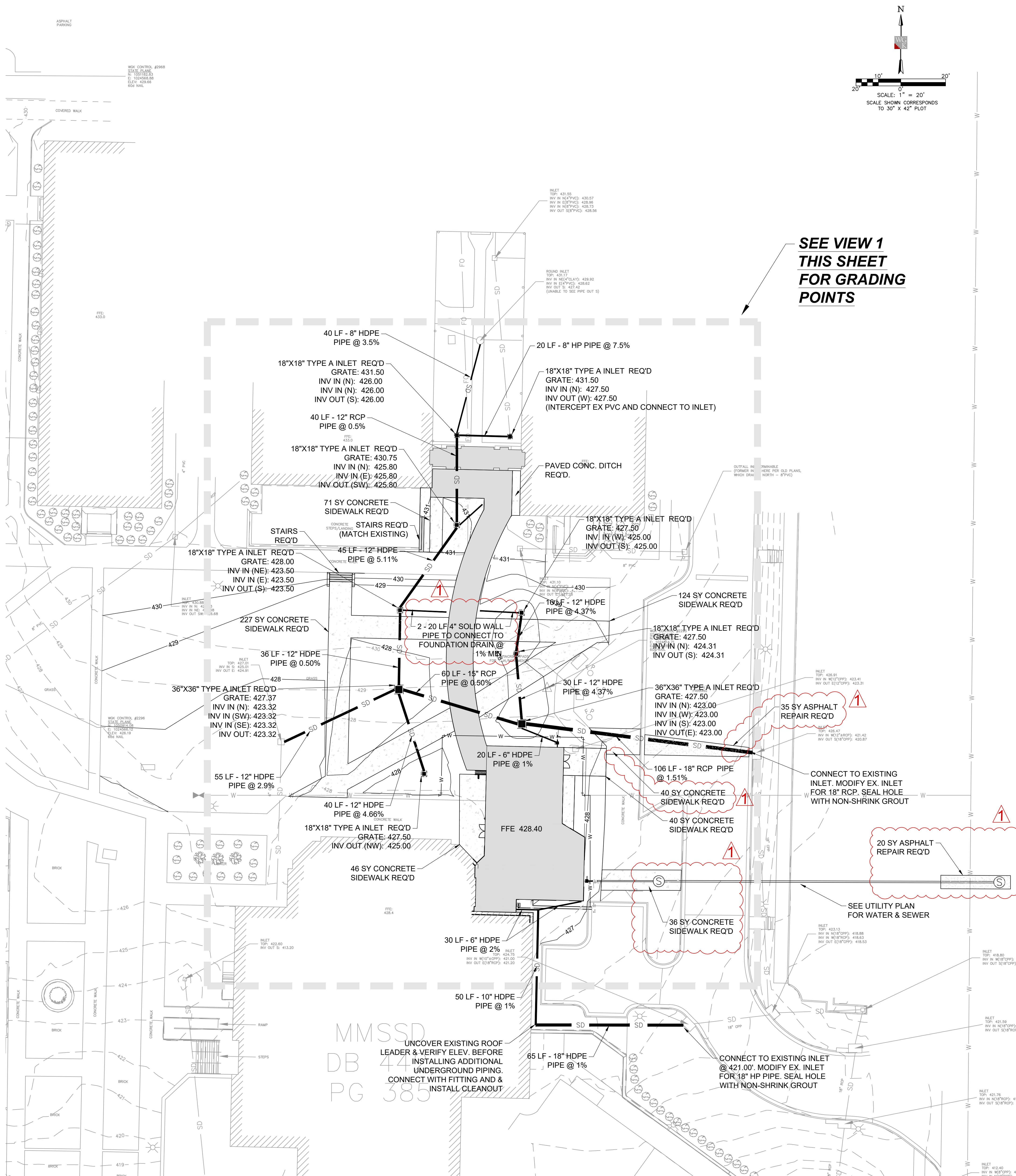

**SEE VIEW 1
THIS SHEET
FOR GRADING
POINTS**

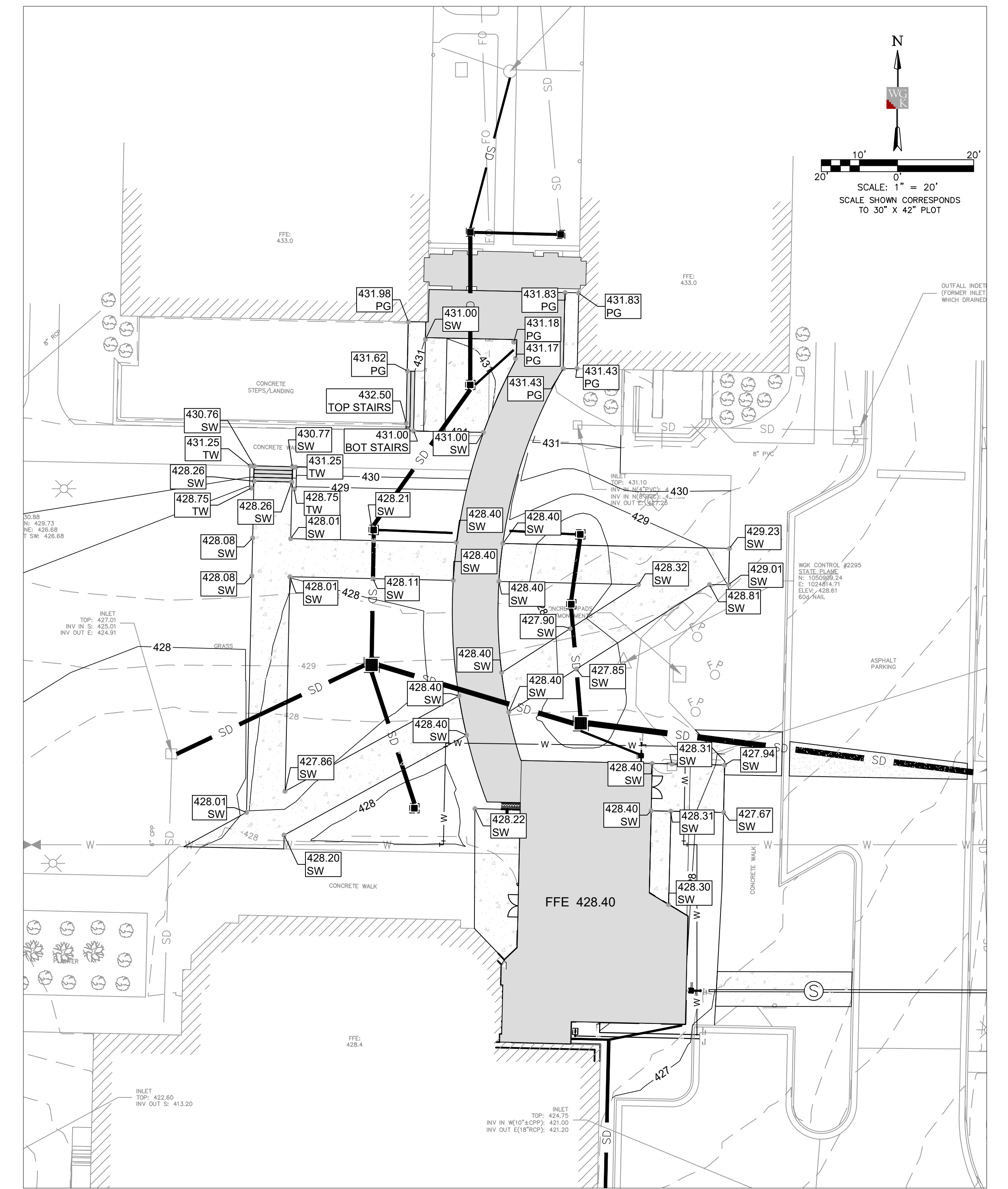

VIEW 1